

SWIVEL LINE

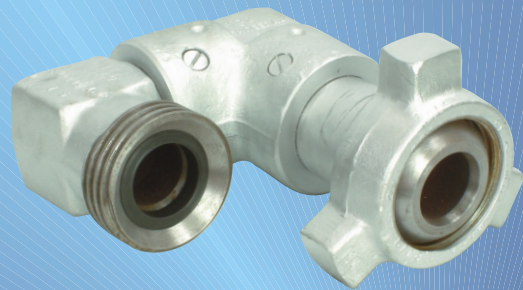

SHREERAJ INDUSTRIES

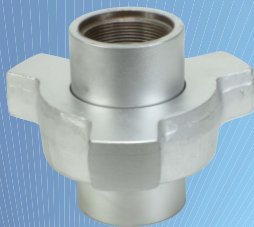
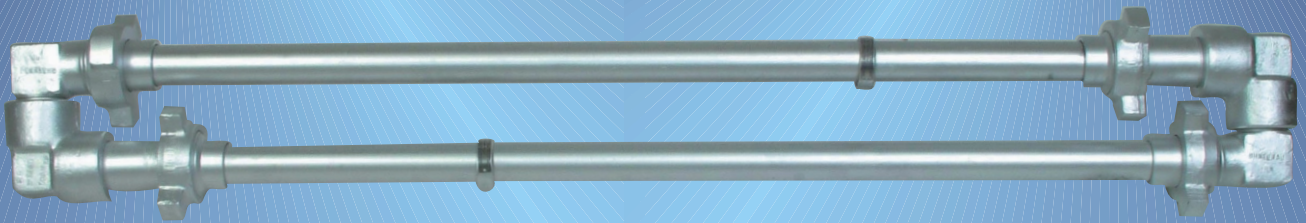

HAMMER UNION

INTRODUCTION

Shreeraj Industries Wing Unions are used for quick connection of suction and pressure pipelines for Gas, Liquids, Oil, Crude, Sludge and Dry media. Robust construction ensures reliability even under the most arduous operating conditions.

Shreeraj Industries Hammer Unions are manufactured in accordance with service conditions in sizes 1" to 6" with pressure rating up to 1000 bar. Hammer Unions for Sour Service are manufactured in accordance with NACE MR-01-75 and API RP-14E.

FEATURES

The conical and spherical surfaces of the female and male subs respectively form an effective metal-to-metal seal in case of low-pressure services.

For Medium Pressure, mostly a nitrile 'O' ring is provided in the male sub in addition to the metal-to-metal seal.

For High Pressure, a lip type seal ring of nitrile is provided for Primary Seal in the female sub. The seal protects tie secondary metal-to-metal seal from corrosion and limits fluid flow turbulence.

For Sour service applications viton seals are provided.

Shreeraj Industries Unions are manufactured using modern manufacturing techniques to attain first class workmanship and dimensional control.

Correctly chosen raw materials for a particular service ensure better service and longer life in extreme conditions.

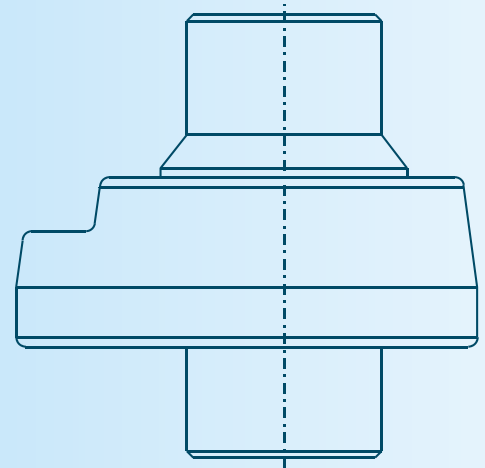

UNION FIG. NO.	END CONNECTIONS	PRESSURE (PSI)			
		STANDARD SERVICE		SOUR SERVICE	
		C.W.P.	T.P.	C.W.P.	T.P.
206	Threaded/ Butt - Weld	2000	3000	-	-
602	Threaded/ Butt - Weld	6000	9000	6000	9000
1002	Threaded/ Butt - Weld	10000	15000	8000	12000
1003	Threaded/ Butt - Weld	10000	15000	-	-
1502	Threaded/ Butt - Weld	15000	22500	10000	15000

SWIVEL JOINTS

INTRODUCTION

Swivel Joints are used in suction and pressure pipeline for Gas, Liquids, Sludge, Oil, Crude and Dry media. Robust construction ensures reliability even under the most arduous operating conditions.

Shreeraj Industries Swivel Joints are manufactured in accordance with service conditions, sizes ranging from 1" to 4" and pressure rating up to 15,000 PSI C.W.P. Swivel joints for sour service are manufactured in accordance with NACE MR-01-75 and API RP-14E.

Various end connections are available, including Line Pipe thread, Weld end, Hammer Union threaded or integral to suit customer specifications. Higher sizes are also available as per customer requirement and specification.

FEATURES

- & Heavy duty construction.
- & Minimum flow restriction.
- & Two/ Three rows of chrome carbon steel balls fitted with hardened S.S. renewable snap rings
For long life and easy maintenance of swivel at site.
- & Primary seal backup with stainless steel ring for easy rotation and longer life of seal.
- & Secondary seal isolates fluid to come in contact with Ball and Ball races and prevent Corrosion.
- & Leak detection plug indicates failure of primary packing.
- & Grease retaining seal keeps away the dirt, dust and other containment out.



STYLE NO. 20

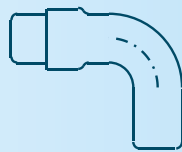

STYLE NO. 30

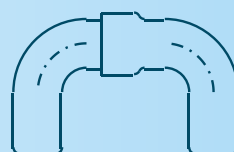

STYLE NO. 40

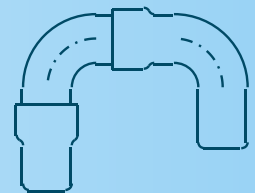

STYLE NO. 50

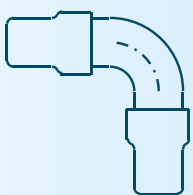

STYLE NO. 60

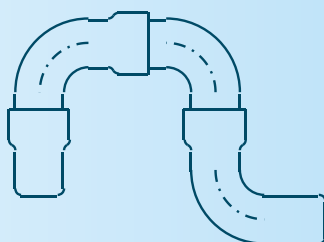

STYLE NO. 70

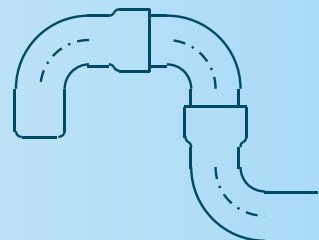

STYLE NO. 80

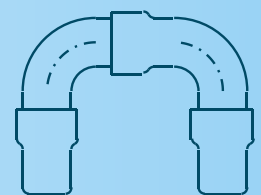

STYLE NO. 10



SWIVEL LINE

INTRODUCTION

Shreeraj Industries manufactures Swivel Lines consisting of Swivel Joints, Pipes and Wing Unions. This cement and circulating all steel flexible hoses offer the widest range of proven design for today's demanding requirements.

Swivel lines are used as suction and pressure pipe lines for Gas, Liquids, Oil, Crude, Sludge and Dry media. Due to their robust construction, these swivel lines provide ideal flexible pipe runs even under heavy duty operating conditions as occurring in drilling and production in the Petroleum Industry.

Shreeraj Industries cement and circulating all steel flexible hoses are available for all standard service requirements, pressure ranging from 6,000 to 15,000 PSI. Hoses for sour service are available upto 10,000 PSI.

The swivel joints used are style 50. Standards Swivel Lines are 12' long when opened. Other style of Swivel Joints and length of Swivel Lines are available on request.



CONSTRUCTION

Swivel Lines are available in Threaded or Welded construction with Hammer Union end.

- ✦ 6000 PSI W.P. : High Pressure Hose, Style 50 Swivel Joints, Threaded or Welded construction.
- ✦ 10,000 PSI W.P. : Long Radius Hose, Style 50 Swivel Joints, Welded construction.
- ✦ 15,000 PSI W.P. : Long Radius Hose, Style 50 Swivel Joints, Welded construction.



Shreeraj Industries

Office & Works:

Block No. 707/ A-2, Nandoli Patia Road,
RANCHARDA - 382 115, District - Gandhinagar, Gujarat, INDIA.

Phone : +91(79) 2754 2813, 2754 3680

E-mail : info@shreerajindia.com